

Dimensions

Description

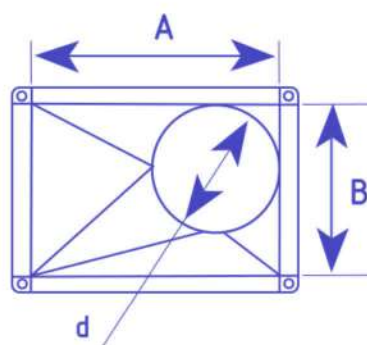
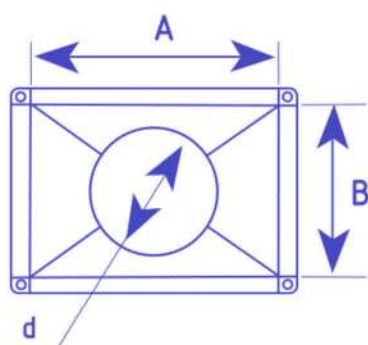

Standards rectangular to circular transition (SRCT) is used for transition between circular and rectangular ducts.

Circular ending is equipped with flange P20/P30 and circular ending is equipped with rubber gasket to ensure necessary level of tightness of the whole system. Pieces are made of galvanized metal sheet.

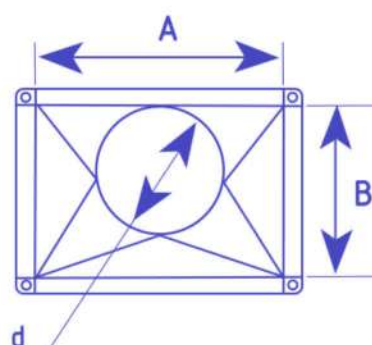
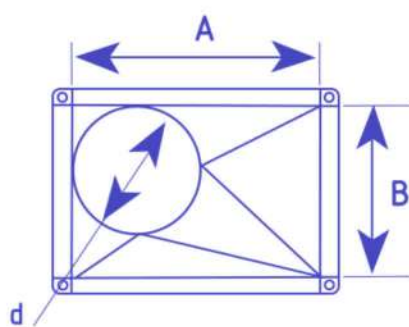

Order example:

SRCT - A1*A2 - B1*B2 - d

type —
 dimensions A —
 dimensions B —
 diameter —